

FUSIBLE LINK THERMAL SHUT OFF VALVES

2" External Emergency Valve w/ Monitor

(FUSIBLE-VLV-SW)+size

Features:

Designed for installation in the piping on an Aboveground Storage Tank where product flow must be stopped in case of fire. The External Thermal Emergency Valve is engineered for rugged use with components designed of high-grade ductile iron and brass. Thermal shock rating of 200 PSI WOG. Fuse Link Melting point of 158 degrees F. The "O" Ring is made of fuel resistant PTFE (Encapsulated Fluorocarbon Elastomer) and the gasket is made form Fuel resistant TFE (Tetra Fluro Ethylene) The standard model has 2" NPT threads on the inlet and outlet openings.

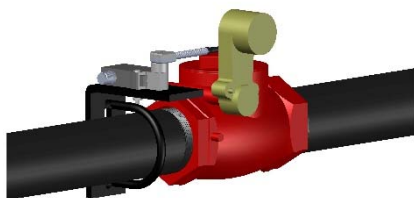

Operation

A fusible spring lever is provided to manually close the valve once put into operation, the valve is held open against the torque of the spring pack by the fusible link. If subjected to temperatures greater than 158° F the fusible link melts and the valve slams closed. The intergraded UL listed supervisory micro switch is equipped with an automatic fuel shut-off limit switch assembly. This switch is then wired to the Fuel Oil Control System to provide signal that the Fire safety valve has been activated and loss of fuel supply flow alarms and interlock fuel oil pump set lockout. The industrial supervisory switches have an IP67 rating with one normally open and closed switch (SPDT). The M12 quick cable connector has status LEDs indicating the signal status to the Fuel Oil Controller.

Standard Sizes Are: ½" – 2" NPT, 2" – 4" Flanged

Part Numbers Are: FUSIBLE-VLV-SW (0.50, 0.75, 1.0, 1.50, 2.00-N), (2F, 3F, 4F) example (FUSIBLE-VLV-SW 2F)

6847 Ellicott Drive, Suite A, East Syracuse, NY 13257

Main 315-403-9985 ~ Fax 315-295-2613

www.LakesidePetroleum.com ~ Joe@LakesidePetroleum.com